

# Apartment 2 camere - 1003, parter, tronson 1 Str. George Ranetti, Nr. 2-8, Sector 6

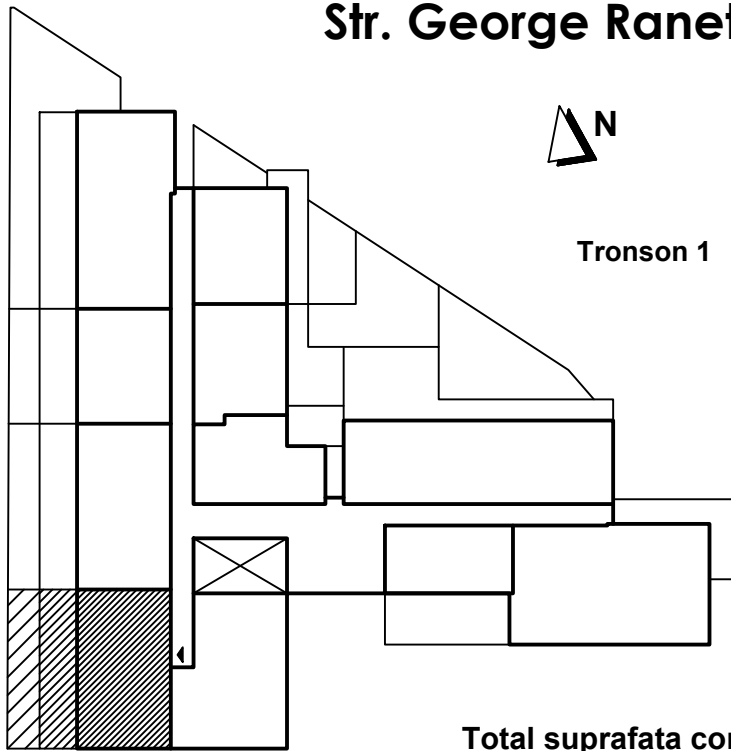

Tronson 1

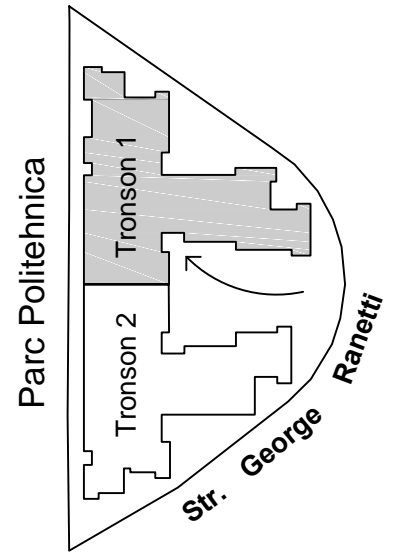

**Total suprafata construita apartament = 127.10 mp, din care:**  
 - suprafata construita terasa = 29.50 mp  
 - suprafata construita gradina = 24.30 mp  
**Total suprafata utila apartament = 88.80 mp**

